



Invitation to Tender

CASTLEGAR & DISTRICT RECREATION COMPLEX R6-R7 ROOF REPLACEMENT PRJ #25034

ADDENDUM NO. 3

Issued: March 17, 2026

Closing Date: 2:00 pm Local Time, March 31, 2026

This Addendum shall be read in conjunction with and considered as an integral part of the Contract Documents; revisions supersede the information contained in the original specifications or previously issued Addendum. Price submitted shall include all items of this Addendum.

By this **Addendum No. 3**, dated March 17, 2026, the Invitation to Tender documents for PRJ25034: Castlegar & District Recreation Complex R6-R7 Roof Replacement shall be amended as specified below.

Drawing Revision

See attached revised drawing A1.02 and A2.02 showing cladding detail on CMU walls.

Except as modified by this Addendum No. 3, Addendum No. 2 issued March 12, 2026 and Addendum No 1. issued February 19, 2026, the Invitation to Tender documents for PRJ25034 shall remain unchanged.

A handwritten signature in blue ink, appearing to read "AJ Evenson".

AJ Evenson
Senior Project Manager

Attachment A: Addendum 3 Block Wall Cladding_Mar16_2026.pdf

LEGEND

	ROOF DRAIN
	ELECTRICAL OR SERVICE STACK
	SCUPPER DRAIN
	PLUMBING STACK
	ROOF SLOPE
	B-VENT
	ROOF CURB
	EQUIPMENT ABOVE ROOF LEVEL
	ROOF PARAPET
	FREE STANDING COMPONENTS
	EXHAUST VENTILATION
	SERVICE LINE ABOVE ROOF
	CHIMNEY
	WALK PAD
	ROOF HATCH
	LIGHT FIXTURE

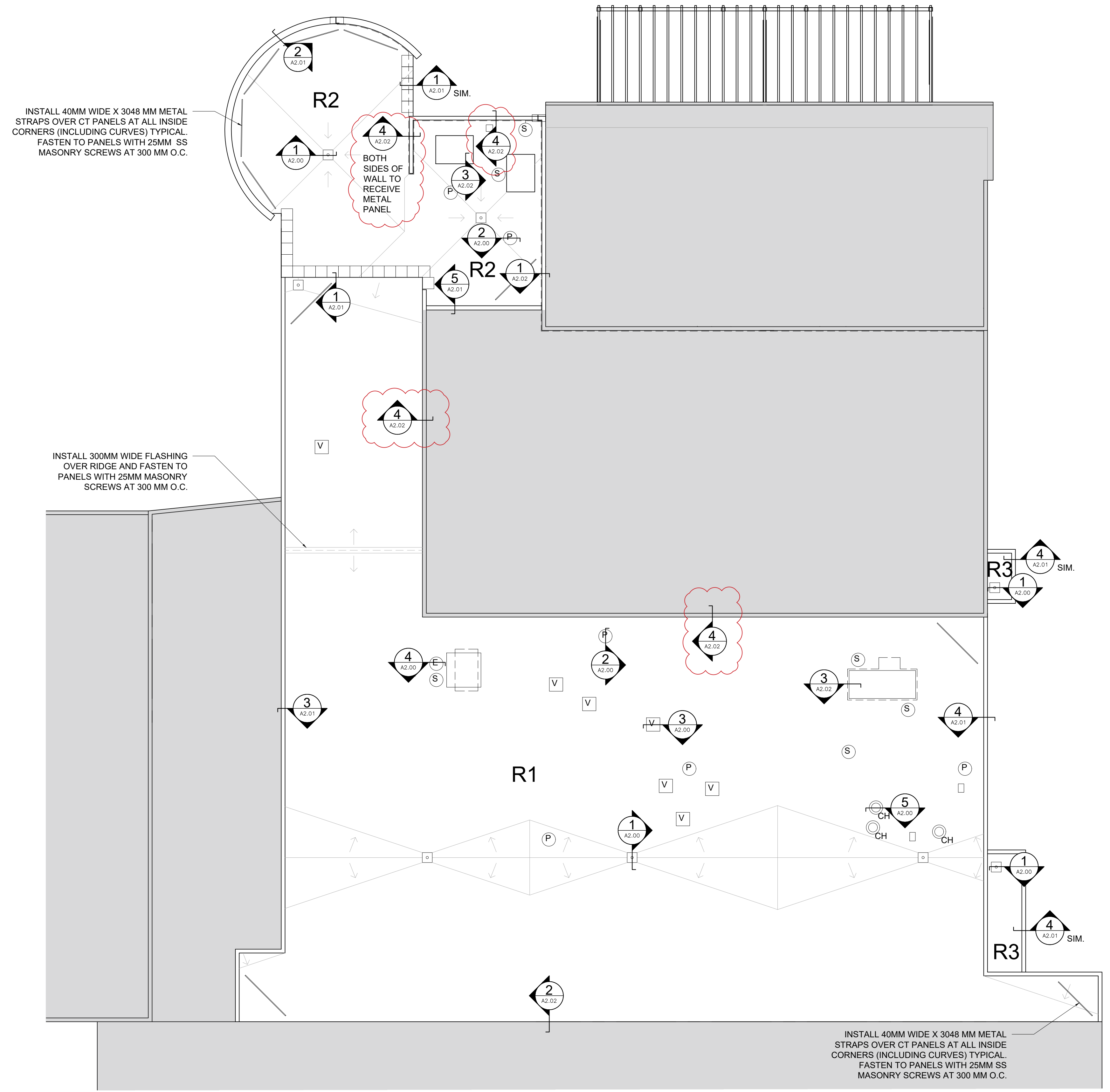

1 ROOF PLAN
 SCALE: 3/32" = 1'-0"

DISCLAIMER:
 All drawings, plans, models, designs, specifications and other documents prepared by Evoke Buildings Inc. are the property of Evoke whether the work is executed or not. Evoke reserves the copyright in them and in the work associated from them and they shall not be used for any other work or project. These drawings may not be suitable for use on "As-Built" drawings unless written permission is obtained from Evoke. The work constructed may vary from what is shown on these drawings. Use of these drawings is limited to what is identified in the version description column.

VERSION	DESCRIPTION	YYYY-MM-DD
3	ISSUED FOR ADDENDUM 3	2026-03-16
2	ISSUED FOR TENDER	2025-05-23
1	ISSUED FOR 90% REVIEW	2025-05-09

DATE:	DESIGNED:	DRAWN:
2024.12.20	AM	NM
SCALE:		SHEET NO.
3/32"=1'-0"		A1.02
APPROVED BY:	DEREK BUDDÉ P.ENG	

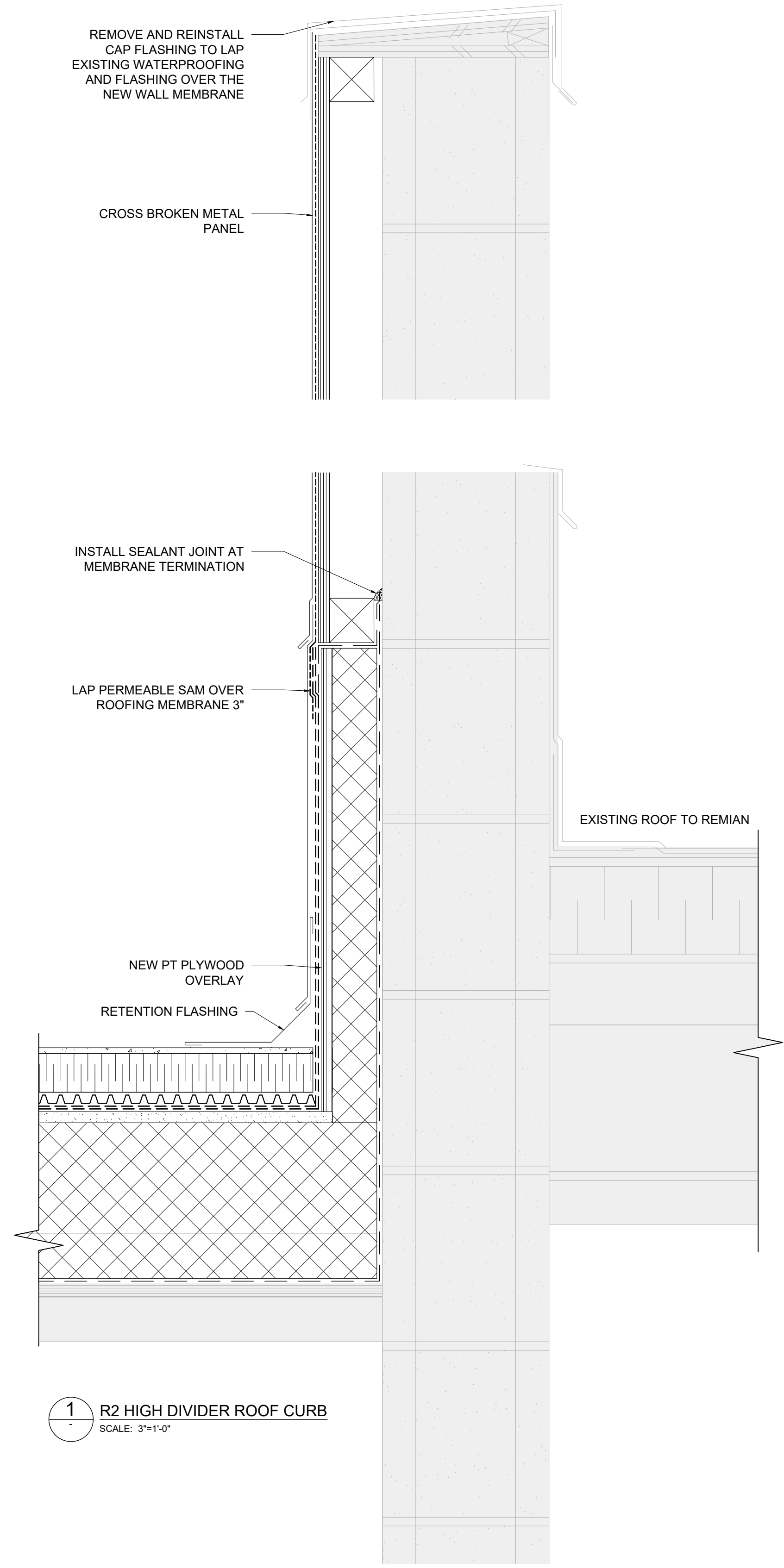

1 R2 HIGH DIVIDER ROOF CURB
 SCALE: 3"=1'-0"

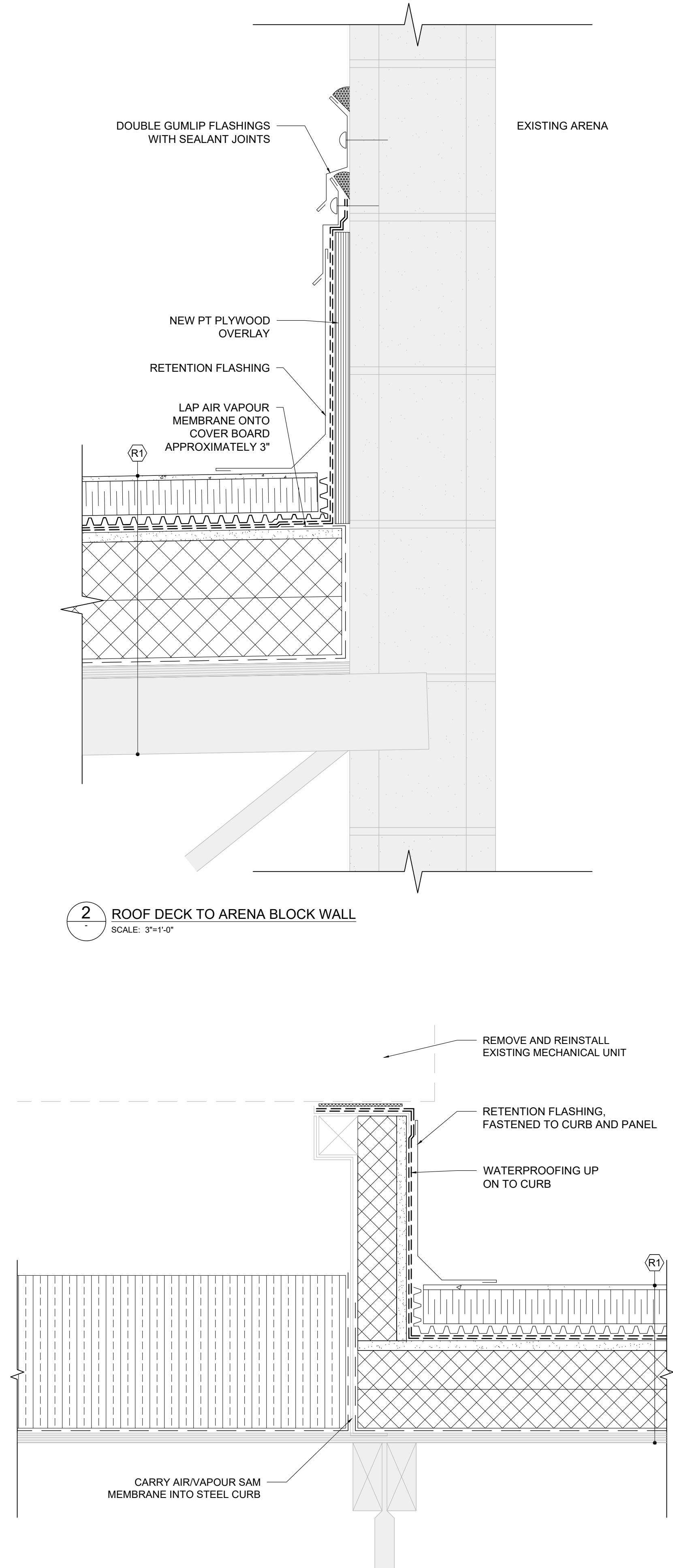

2 ROOF DECK TO ARENA BLOCK WALL
 SCALE: 3"=1'-0"

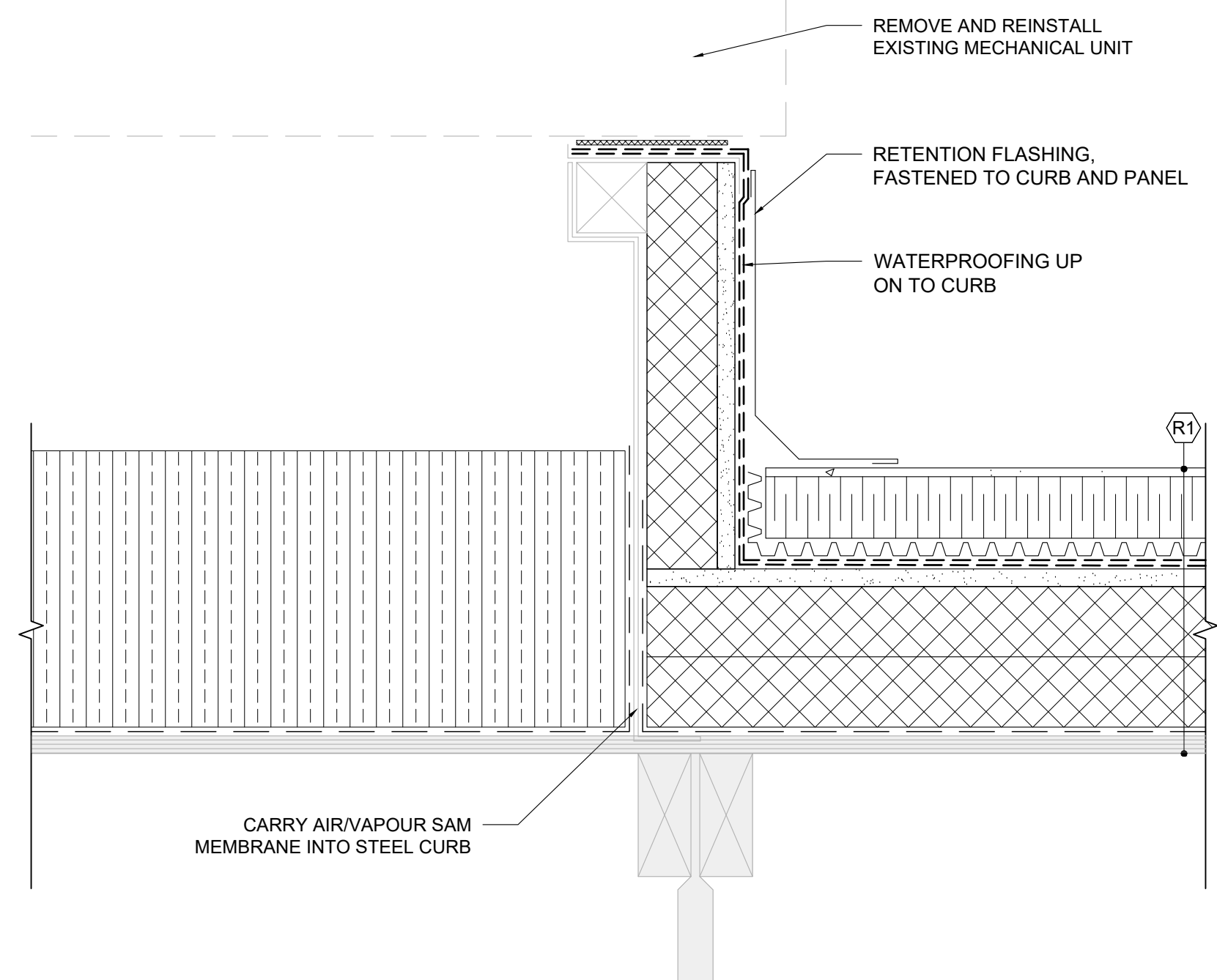

3 EXISTING MECHANICAL CURB DETAIL
 SCALE: 3"=1'-0"

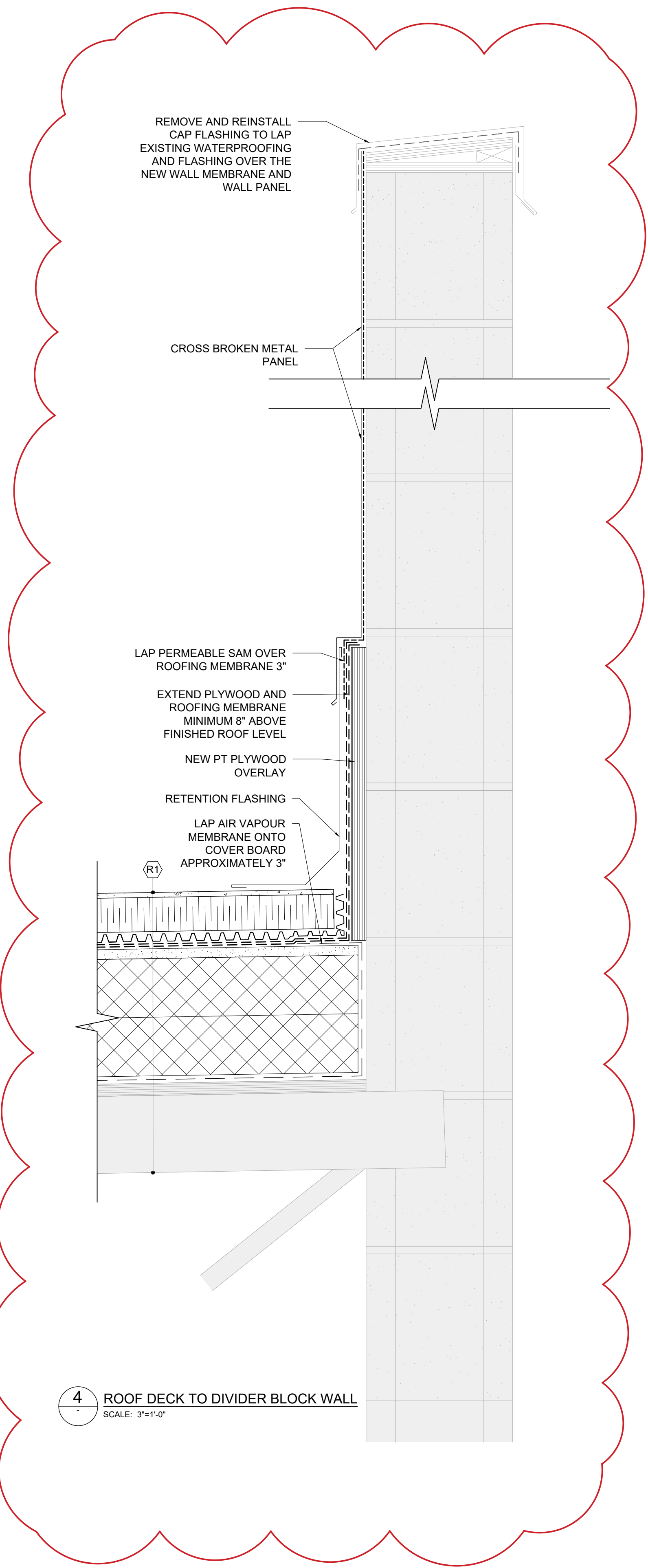

4 ROOF DECK TO DIVIDER BLOCK WALL
 SCALE: 3"=1'-0"

DISCLAIMER:
 All drawings, plans, models, designs, specifications and other documents prepared by Evoke Buildings Inc. are the property of Evoke whether the work is executed or not. Evoke reserves the copyright in them and in the work associated with them and they shall not be used for any other work or project. These drawings may not be suitable for use on "as-is" drawings unless written permission is obtained from Evoke. The work constituted may vary from what is shown on these drawings. Use of these drawings is limited to what is identified in the version description columns.

VERSION	DESCRIPTION	YYYY-MM-DD
3	ISSUED FOR CONSTRUCTION	2025-07-11
2	ISSUED FOR TENDER	2025-05-23
1	ISSUED FOR 90% REVIEW	2025-05-09

DATE: 2024.12.20	DESIGNED: AM	DRAWN: NM
SCALE: 3"=1'-0"	SHEET NO. A2.02	
APPROVED BY: DEREK BUDDE P.ENG		